

# UNLOCK IT!

BY YMCA OF THE NORTH



**Theodore Wirth Regional Park** - Beach House, 3200 Glenwood Ave, Minneapolis, MN 55405

*Unlock It!* is a fun adventure challenge for all ages. Using your feet, problem-solving ability and teamwork, follow the clues to reveal a set of letters. Once you have all the letters, unscramble them to form the keyword that solves this *Unlock It!*

*Hint: When you solve this Unlock It! you will feel this way.*

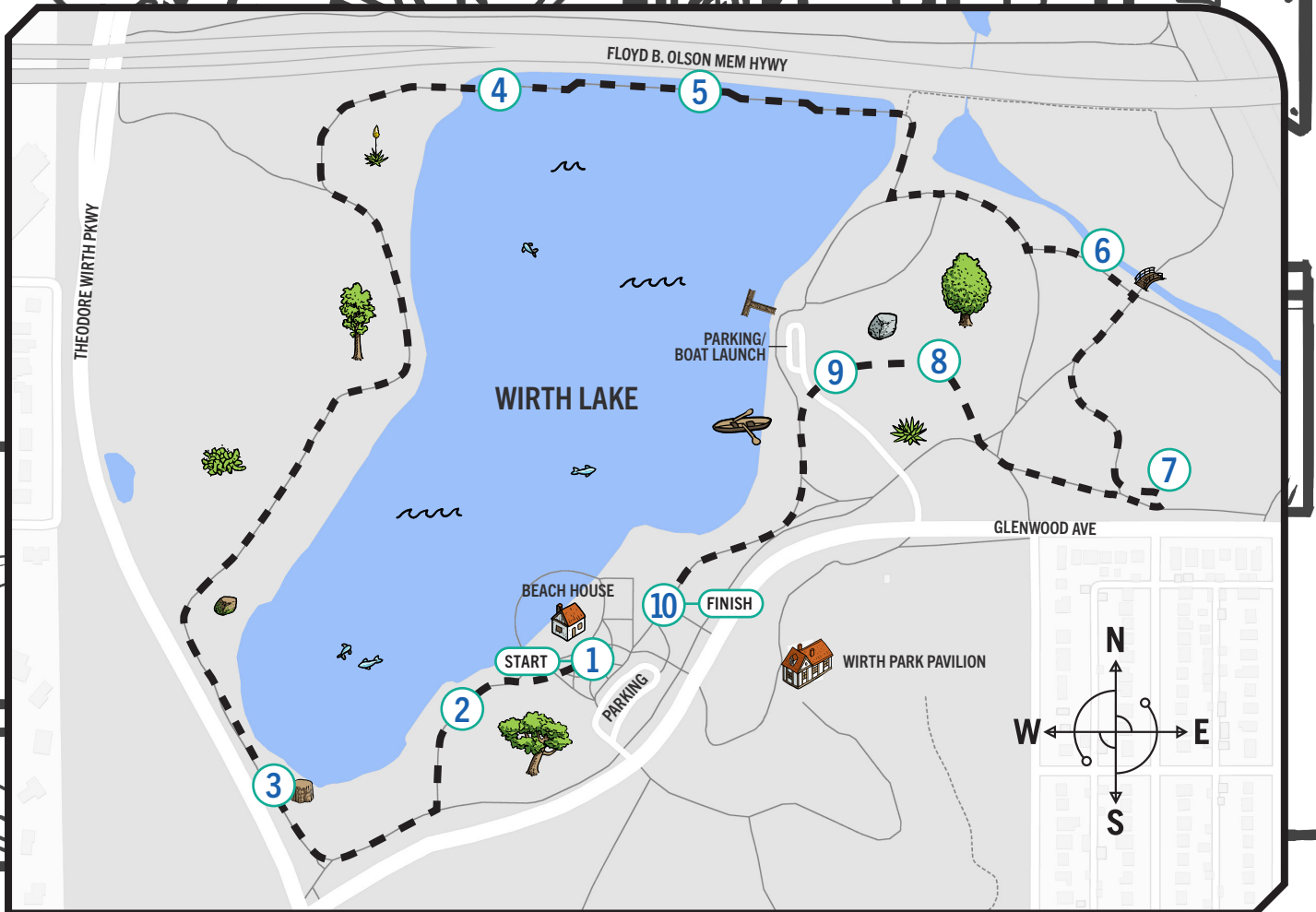

PRESENTED BY



HealthPartners  
Park Nicollet

The answers to the clues below reveal key letters needed to solve your *Unlock It!* adventure.

CLUE

Starting at the beach house, what total number do you get by adding the number of white pillars on the front and back of the building to the number of volleyball courts?

1

What letter is that number in the alphabet?

CLUE

Walk clockwise on the paved path around the lake. As you cross the first walking bridge, what plant is both growing in the water and depicted in the rails of the bridge?

2

\_\_\_\_\_

CLUE

Which compass direction was this once magnificent tree in danger of falling when it was cut down? Circle the best answer below and use the underlined letter from that word.

3

S O U T H W E S T OR N O R T H E A S T

CLUE

Enjoy the forests as you walk along the west side of Wirth Lake until you arrive at the long walk bridge. What shape that occurs in nature is depicted in the railing along the bridge?

4

\_\_\_\_\_

CLUE

Highway 55 on your left goes all the way to North Dakota. Look for a sign that shows how many miles you are from North Dakota. \_\_\_\_\_ Spell out that number below.

5

\_\_\_\_\_

CLUE

Follow the trail route shown on the map until you are next to Basset Creek. Does the water flow toward or away from Highway 55? Circle the answer below and use the highlighted letter from your answer.

6

T O W A R D OR A W A Y F R O M

CLUE

Look closely at all the panels of the chair to determine one specific bird the artist painted 7 times on the chair. What is its name?

7

\_\_\_\_\_

CLUE

Walk onto the grass, past the big pine trees to the top of the hill, where you will find the memorial to Minnesota's Finnish immigrants. Finish the statement: "...through their ideals, industry, and..."

8

\_\_\_\_\_

CLUE

Near the boat launch you'll find this old pump. What town was it manufactured in?

9

\_\_\_\_\_

CLUE

On the way back to the beach, find this historical marker. Which Olympic medalist and Hollywood star performed here at Wirth in 1943?

10

\_\_\_\_\_

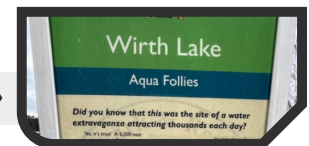

Carry down the letters from the clues above into the placeholder shown for each clue #.

Clue # 1 2 3 4 5 6 7 8 9 10

Now complete your *Unlock It!* adventure by unscrambling the letters into your keyword.

\_\_\_\_\_

Congratulations!



Use the QR code to submit the keyword for a chance to win fun prizes. Or visit the website below.

[ymcanorth.org/unlock-it-keyword](http://ymcanorth.org/unlock-it-keyword)